

09\_02B/299

**2021CPT.03.03.20651**

See Sheet 1A For Index of Sheets  
See Sheet 1B For Conventional Symbols

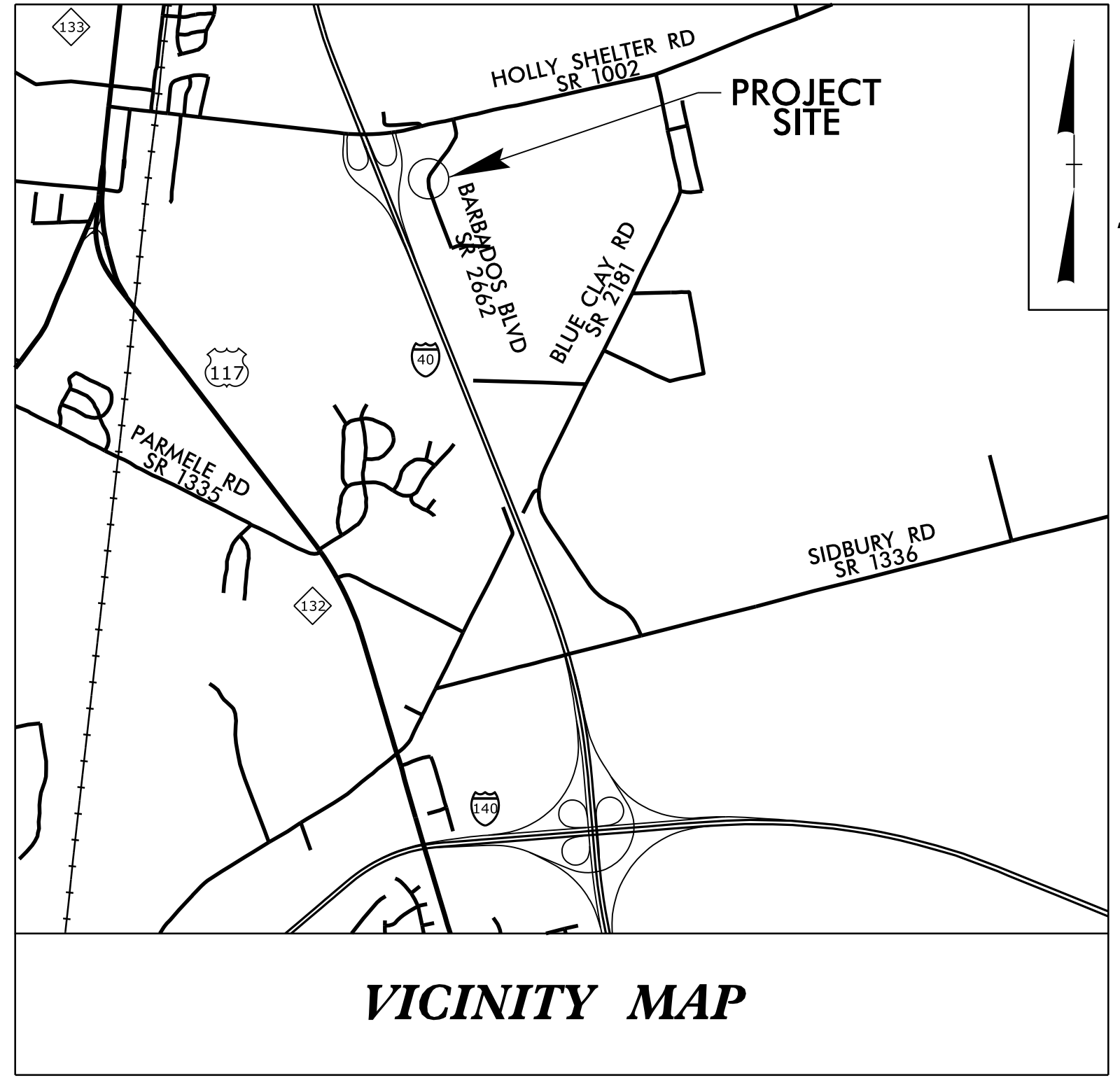

**VICINITY MAP**

STATE OF NORTH CAROLINA  
DIVISION OF HIGHWAYS

**NEW HANOVER COUNTY**

**LOCATION: ROADWAY IMPROVEMENT TO BARBADOS BLVD  
JUST SOUTH OF SR 1002 (HOLLY SHELTER ROAD)  
IN NEW HANOVER COUNTY**

**TYPE OF WORK: GRADING AND PAVING**

STATE	STATE PROJECT REFERENCE NO.	SHEET NO.	TOTAL SHEETS
N.C.	2021CPT.03.03.20651	1	
STATE PROJ. NO.	F.A. PROJ. NO.	DESCRIPTION	
2021CPT.03.03.20651		PE	
2021CPT.03.03.20651		CONST	

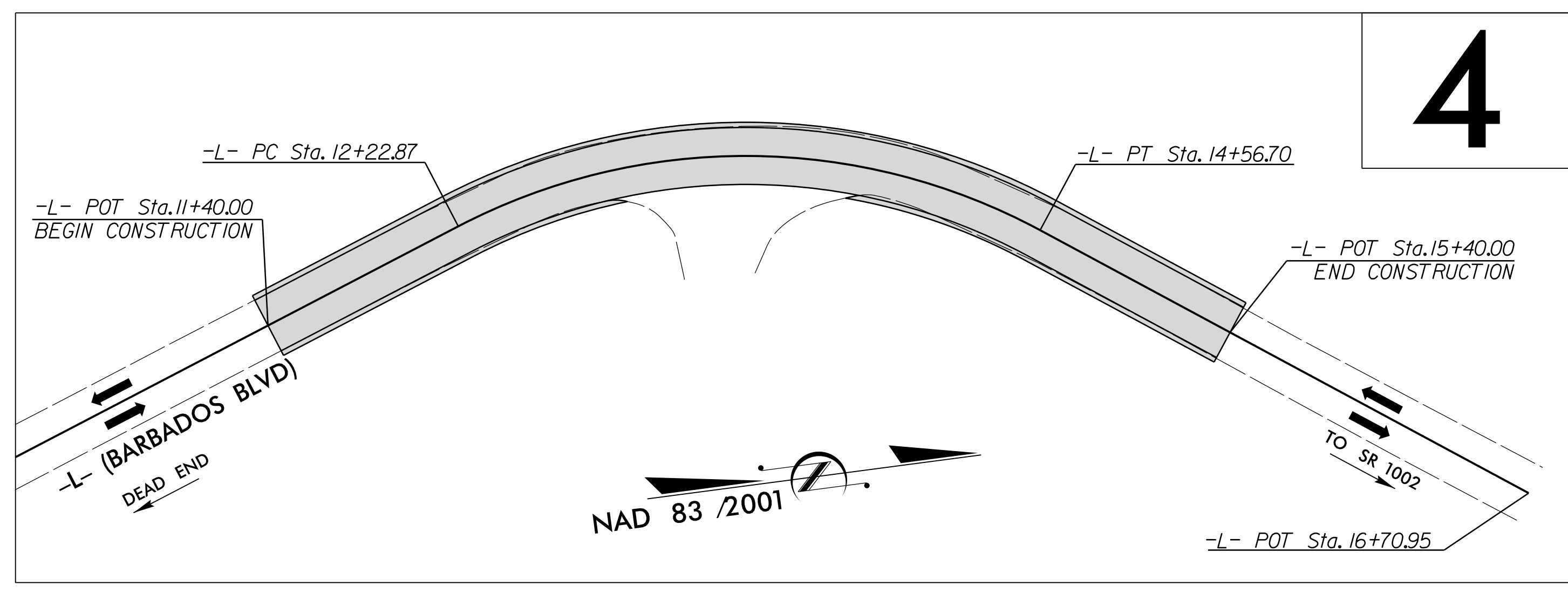

**4**

DOCUMENT NOT CONSIDERED FINAL  
UNLESS ALL SIGNATURES COMPLETED

**CONTRACT: DC00294**

**GRAPHIC SCALES**

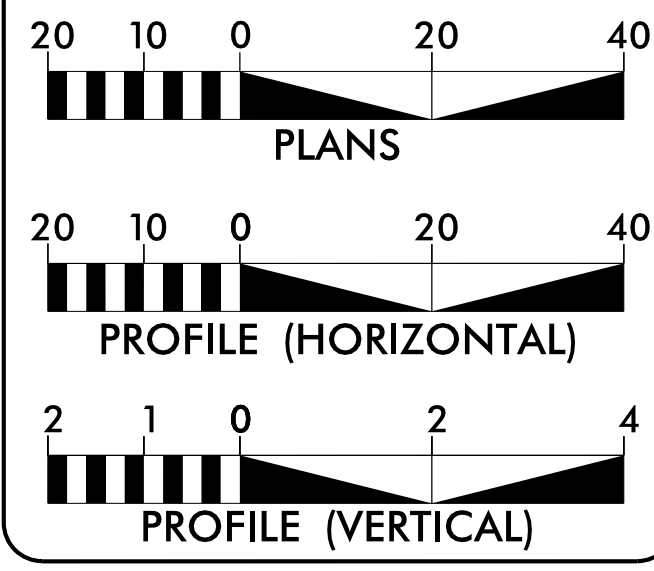

**DESIGN DATA**

ADT 2018 = 800  
ADT =  
K = 10 %  
D = 60 %  
T = 17 % \*  
V = 50 MPH  
\* TTST = 0% DUAL = 17%  
FUNC CLASS =  
LOCAL  
REGIONAL TIER

**PROJECT LENGTH**

LENGTH OF ROADWAY = 0.076 MILES

Prepared for the North Carolina Department of Transportation in the office of:

PLANS PREPARED BY:

**PARSONS**  
5540 Corporate Center, Suite 217  
Raleigh, NC 27617  
N.C. LICENSE NO. P-14248  
FOR NORTH CAROLINA DEPARTMENT OF TRANSPORTATION

2018 STANDARD SPECIFICATIONS

RIGHT OF WAY DATE:

LETTING DATE:  
OCTOBER 15, 2020

DAVID L. WILVER, PE  
PROJECT ENGINEER

J. MATTHEW PICKENS, PE  
PROJECT DESIGN ENGINEER

LYDIA MCKEEL, PE  
NCDOT CONTACT

SIGNATURE: \_\_\_\_\_ P.E.

ROADWAY DESIGN ENGINEER

SEAL: 37950, 9/21/2020

DocuSigned by:  
Jason M. Pickens, PE  
JASON M. PICKENS  
SIGNATURE: \_\_\_\_\_ P.E.

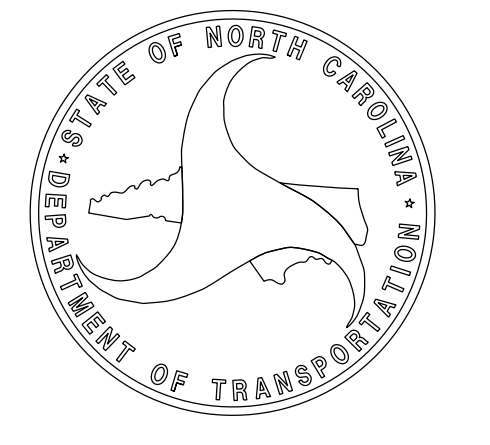

16-SEP-2020 12:57  
J:\Barbados Blvd\_Curve\Roadway\Proj\Barbados\_RDY\_TSH\_01.dgn  
\$\$\$\$\$SERVNAME\$\$\$\$\$

8/17/19

PLANS PREPARED BY :  
**PARSONS**  
 RALEIGH, NORTH CAROLINA, (919) 854-1345  
 NC LICENSE NO. F-0246  
 FOR NORTH CAROLINA DEPT. OF TRANSPORTATION

PROJECT REFERENCE NO.	SHEET NO.
2021CPT.03.03.20651	1A

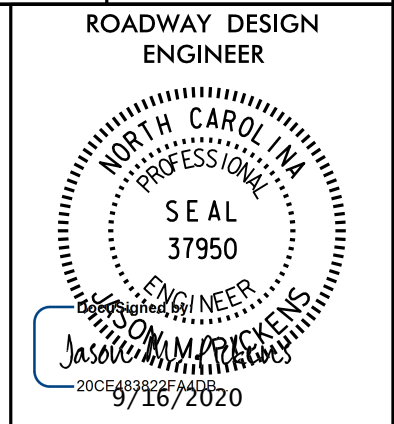

**DOCUMENT NOT CONSIDERED FINAL  
UNLESS ALL SIGNATURES COMPLETED**

INDEX OF SHEETS	
SHEET NUMBER	SHEET
1	TITLE SHEET
1A	INDEX OF SHEETS, GENERAL NOTES, AND STANDARD DRAWINGS
1B	CONVENTIONAL SYMBOLS
2A-1	PAVEMENT SCHEDULE AND TYPICAL SECTION
2C-1	MODIFIED METHOD III DETAIL
3B-1	ROADWAY SUMMARY
4	PLAN & PROFILE SHEET
X-1A	CROSS-SECTION SUMMARY SHEET
X-1 THRU X-3	CROSS-SECTIONS

**GENERAL NOTES:**

2018 SPECIFICATIONS  
 EFFECTIVE: 01-16-2018  
 REVISED:

**GRADING AND SURFACING OR RESURFACING AND WIDENING:**

THE GRADE LINES SHOWN DENOTE THE FINISHED ELEVATION OF THE PROPOSED SURFACING AT GRADE POINTS SHOWN ON THE TYPICAL SECTIONS. WHERE NO GRADE LINES ARE SHOWN, THE PROFILES SHOWN DENOTE THE TOP ELEVATION OF THE EXISTING PAVEMENT ALONG THE CENTER LINE OF SURVEY ON WHICH THE PROPOSED RESURFACING WILL BE PLACED. GRADE LINES MAY BE ADJUSTED BY THE ENGINEER IN ORDER TO SECURE A PROPER TIE-IN.

**CLEARING:**

CLEARING ON THIS PROJECT SHALL BE PERFORMED TO THE LIMITS ESTABLISHED BY MODIFIED METHOD III.

**SUPERELEVATION:**

ALL CURVES ON THIS PROJECT SHALL BE SUPERELEVATED IN ACCORDANCE WITH STD. NO. 225.04 USING THE RATE OF SUPERELEVATION AND RUNOFF SHOWN ON THE PLANS. SUPERELEVATION IS TO BE REVOLVED ABOUT THE GRADE POINTS SHOWN ON THE TYPICAL SECTIONS.

**SHOULDER CONSTRUCTION:**

ASPHALT, EARTH, AND CONCRETE SHOULDER CONSTRUCTION ON THE HIGH SIDE OF SUPERELEVATED CURVES SHALL BE IN ACCORDANCE WITH STD. NO. 560.01

**2018 ROADWAY ENGLISH STANDARD DRAWINGS**

The following Roadway Standards as appear in "Roadway Standard Drawings" Highway Design Branch - N. C. Department of Transportation - Raleigh, N. C., Dated January, 2018 are applicable to this project and by reference hereby are considered a part of these plans:

STD.NO.	TITLE
DIVISION 2 - EARTHWORK	
200.03	Method of Clearing - Modified Method III (See Detail in Lieu of Standard)
225.02	Guide for Grading Subgrade - Secondary and Local
225.04	Method of Obtaining Superelevation - Two Lane Pavement
DIVISION 5 - SUBGRADE, BASES AND SHOULDERS	
560.01	Method of Shoulder Construction - High Side of Superelevated Curve - Method I
DIVISION 6 - ASPHALT BASES AND PAVEMENTS	
654.01	Pavement Repairs

EFF. 01-16-2018  
REV.

# STATE OF NORTH CAROLINA, DIVISION OF HIGHWAYS CONVENTIONAL PLAN SHEET SYMBOLS

## BOUNDARIES AND PROPERTY:

State Line	-----
County Line	-----
Township Line	-----
City Line	-----
Reservation Line	-----
Property Line	-----
Existing Iron Pin	○ EIP
Computed Property Corner	-----
Property Monument	□ ECM
Parcel/Sequence Number	①23
Existing Fence Line	-x-x-x-
Proposed Woven Wire Fence	○
Proposed Chain Link Fence	□
Proposed Barbed Wire Fence	◇
Existing Wetland Boundary	----- WLB
Proposed Wetland Boundary	----- WLB
Existing Endangered Animal Boundary	----- EAB
Existing Endangered Plant Boundary	----- EPB
Existing Historic Property Boundary	----- HPB
Known Contamination Area: Soil	☠-S-☠
Potential Contamination Area: Soil	☠-S-☠
Known Contamination Area: Water	☠-W-☠
Potential Contamination Area: Water	☠-W-☠
Contaminated Site: Known or Potential	☠?

## BUILDINGS AND OTHER CULTURE:

Gas Pump Vent or U/G Tank Cap	○
Sign	○ S
Well	○ W
Small Mine	✕
Foundation	□
Area Outline	□
Cemetery	□
Building	□
School	□
Church	□
Dam	□

## HYDROLOGY:

Stream or Body of Water	-----
Hydro, Pool or Reservoir	□
Jurisdictional Stream	----- JS
Buffer Zone 1	----- BZ 1
Buffer Zone 2	----- BZ 2
Flow Arrow	←
Disappearing Stream	→
Spring	○
Wetland	-----
Proposed Lateral, Tail, Head Ditch	-----
False Sump	▽

## RAILROADS:

Standard Gauge	-----
RR Signal Milepost	○ MILEPOST 35
Switch	□ SWITCH
RR Abandoned	-----
RR Dismantled	-----

## RIGHT OF WAY & PROJECT CONTROL:

Secondary Horiz and Vert Control Point	◆
Primary Horiz Control Point	○
Primary Horiz and Vert Control Point	◆
Exist Permanent Easement Pin and Cap	◇
New Permanent Easement Pin and Cap	◆
Vertical Benchmark	▲
Existing Right of Way Marker	△
Existing Right of Way Line	-----
New Right of Way Line	-----
New Right of Way Line with Pin and Cap	-----
New Right of Way Line with Concrete or Granite R/W Marker	-----
New Control of Access Line with Concrete C/A Marker	-----
Existing Control of Access	-----
New Control of Access	-----
Existing Easement Line	----- E
New Temporary Construction Easement	----- E
New Temporary Drainage Easement	----- TDE
New Permanent Drainage Easement	----- PDE
New Permanent Drainage / Utility Easement	----- DUE
New Permanent Utility Easement	----- PUE
New Temporary Utility Easement	----- TUE
New Aerial Utility Easement	----- AUE

## ROADS AND RELATED FEATURES:

Existing Edge of Pavement	-----
Existing Curb	-----
Proposed Slope Stakes Cut	----- C
Proposed Slope Stakes Fill	----- F
Proposed Curb Ramp	----- CR
Existing Metal Guardrail	-----
Proposed Guardrail	-----
Existing Cable Guiderail	-----
Proposed Cable Guiderail	-----
Equality Symbol	⊕
Pavement Removal	-----

## VEGETATION:

Single Tree	○
Single Shrub	○

Note: Not to Scale

\*S.U.E. = Subsurface Utility Engineering

Hedge	-----
Woods Line	-----
Orchard	-----
Vineyard	-----

## EXISTING STRUCTURES:

MAJOR:	
Bridge, Tunnel or Box Culvert	----- CONC
Bridge Wing Wall, Head Wall and End Wall	----- CONC WW
MINOR:	
Head and End Wall	----- CONC HW
Pipe Culvert	-----
Footbridge	-----
Drainage Box: Catch Basin, DI or JB	□ CB
Paved Ditch Gutter	-----
Storm Sewer Manhole	○ S
Storm Sewer	----- S

## UTILITIES:

POWER:	
Existing Power Pole	●
Proposed Power Pole	○
Existing Joint Use Pole	●
Proposed Joint Use Pole	○
Power Manhole	○ P
Power Line Tower	□
Power Transformer	□
U/G Power Cable Hand Hole	-----
H-Frame Pole	●
U/G Power Line LOS B (S.U.E.*)	----- P
U/G Power Line LOS C (S.U.E.*)	----- P
U/G Power Line LOS D (S.U.E.*)	----- P

## TELEPHONE:

Existing Telephone Pole	●
Proposed Telephone Pole	○
Telephone Manhole	○ T
Telephone Pedestal	□
Telephone Cell Tower	⬇
U/G Telephone Cable Hand Hole	-----
U/G Telephone Cable LOS B (S.U.E.*)	----- T
U/G Telephone Cable LOS C (S.U.E.*)	----- T
U/G Telephone Cable LOS D (S.U.E.*)	----- T
U/G Telephone Conduit LOS B (S.U.E.*)	----- TC
U/G Telephone Conduit LOS C (S.U.E.*)	----- TC
U/G Telephone Conduit LOS D (S.U.E.*)	----- TC
U/G Fiber Optics Cable LOS B (S.U.E.*)	----- T FO
U/G Fiber Optics Cable LOS C (S.U.E.*)	----- T FO
U/G Fiber Optics Cable LOS D (S.U.E.*)	----- T FO

## WATER:

Water Manhole	○ W
Water Meter	○
Water Valve	⊗
Water Hydrant	⊕
U/G Water Line LOS B (S.U.E.*)	-----
U/G Water Line LOS C (S.U.E.*)	-----
U/G Water Line LOS D (S.U.E.*)	-----
Above Ground Water Line	----- A/G Water

## TV:

TV Pedestal	□
TV Tower	⊗
U/G TV Cable Hand Hole	-----
U/G TV Cable LOS B (S.U.E.*)	----- TV
U/G TV Cable LOS C (S.U.E.*)	----- TV
U/G TV Cable LOS D (S.U.E.*)	----- TV
U/G Fiber Optic Cable LOS B (S.U.E.*)	----- TV FO
U/G Fiber Optic Cable LOS C (S.U.E.*)	----- TV FO
U/G Fiber Optic Cable LOS D (S.U.E.*)	----- TV FO

## GAS:

Gas Valve	◇
Gas Meter	◇
U/G Gas Line LOS B (S.U.E.*)	----- G
U/G Gas Line LOS C (S.U.E.*)	----- G
U/G Gas Line LOS D (S.U.E.*)	----- G
Above Ground Gas Line	----- A/G Gas

## SANITARY SEWER:

Sanitary Sewer Manhole	⊕
Sanitary Sewer Cleanout	⊕
U/G Sanitary Sewer Line	----- SS
Above Ground Sanitary Sewer	----- A/G Sanitary Sewer
SS Forced Main Line LOS B (S.U.E.*)	----- FSS
SS Forced Main Line LOS C (S.U.E.*)	----- FSS
SS Forced Main Line LOS D (S.U.E.*)	----- FSS

## MISCELLANEOUS:

Utility Pole	●
Utility Pole with Base	□
Utility Located Object	○
Utility Traffic Signal Box	□
Utility Unknown U/G Line LOS B (S.U.E.*)	-----
U/G Tank; Water, Gas, Oil	□
Underground Storage Tank, Approx. Loc.	□ UST
A/G Tank; Water, Gas, Oil	□
Geoenvironmental Boring	⊕
U/G Test Hole LOS A (S.U.E.*)	⊕
Abandoned According to Utility Records	AATUR
End of Information	E.O.I.



## FINAL PAVEMENT SCHEDULE

CODE	DESCRIPTION	CODE	DESCRIPTION	CODE	DESCRIPTION
C1	PROP. APPROX. 3" ASPHALT CONCRETE SURFACE COURSE, TYPE S9.5B, AT AN AVERAGE RATE OF 165 LBS. PER SQ. YD. IN EACH OF TWO LAYERS	E1	PROP. APPROX. 5" ASPHALT CONCRETE BASE COURSE, TYPE B25.0C, AT AN AVERAGE RATE OF 570 LBS. PER SQ. YD.	T	EARTH MATERIAL.
C2	PROP. APPROX. 1½" ASPHALT CONCRETE SURFACE COURSE, TYPE S9.5B, AT AN AVERAGE RATE OF 165 LBS. PER SQ. YD.	E2	PROP. VAR. DEPTH ASPHALT CONCRETE BASE COURSE, TYPE B25.0C, AT AN AVERAGE RATE OF 114 LBS. PER SQ. YD. PER 1" DEPTH. TO BE PLACED IN LAYERS NOT LESS THAN 3" IN DEPTH OR GREATER THAN 5½" IN DEPTH.	U	EXISTING PAVEMENT
C3	PROP. VAR. DEPTH ASPHALT CONCRETE SURFACE COURSE, TYPE S9.5B, AT AN AVERAGE RATE OF 110 LBS. PER SQ. YD. PER 1" DEPTH. TO BE PLACED IN LAYERS NOT LESS THAN 1" IN DEPTH OR GREATER THAN 1½" IN DEPTH.			W	VARIABLE DEPTH ASPHALT PAVEMENT (SEE STANDARD WEDGING DETAIL ON THIS SHEET).

NOTE: PAVEMENT EDGE SLOPES ARE 1:1 UNLESS SHOWN OTHERWISE.

**PLANS PREPARED BY :**  
**PARSONS**  
RALEIGH, NORTH CAROLINA, (919) 854-1345  
 NC LICENSE NO. F-0246  
 FOR NORTH CAROLINA DEPT. OF TRANSPORTATION

PROJECT REFERENCE NO. <b>2021CPT.03.03.20651</b>	SHEET NO. <b>2A-1</b>
RW SHEET NO.	
ROADWAY DESIGN ENGINEER	PAVEMENT DESIGN ENGINEER

**DOCUMENT NOT CONSIDERED FINAL UNLESS ALL SIGNATURES COMPLETED**

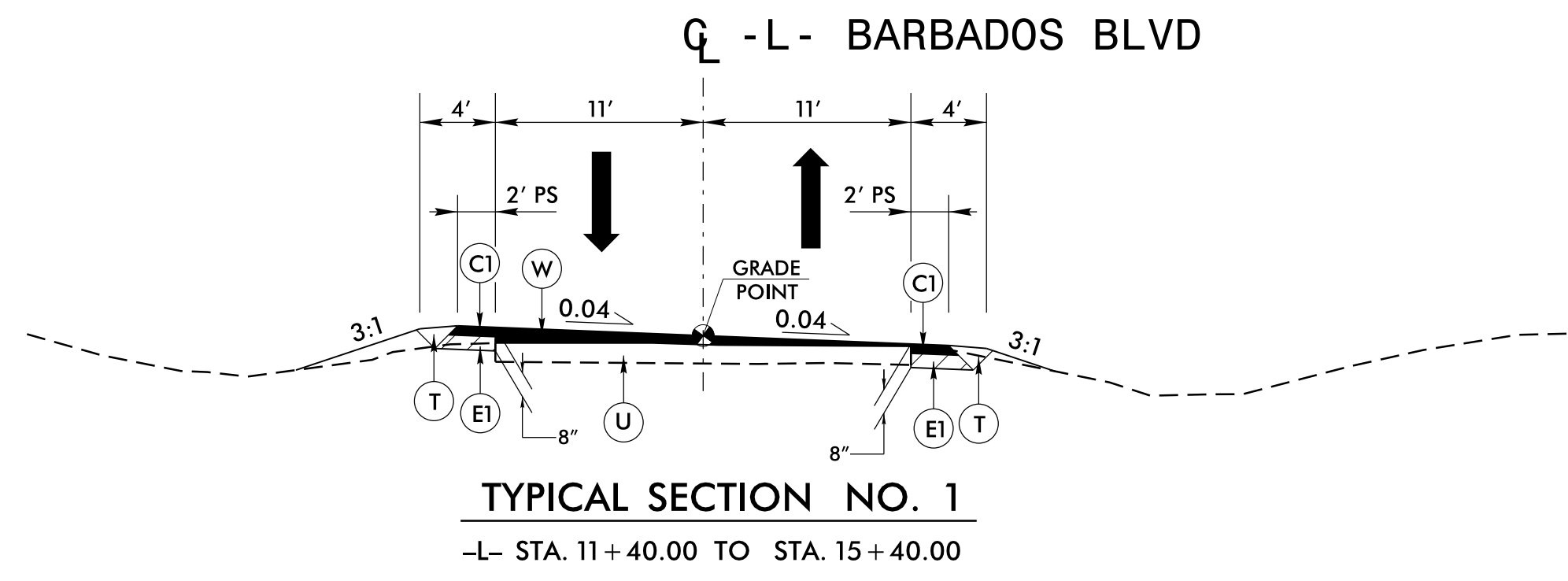
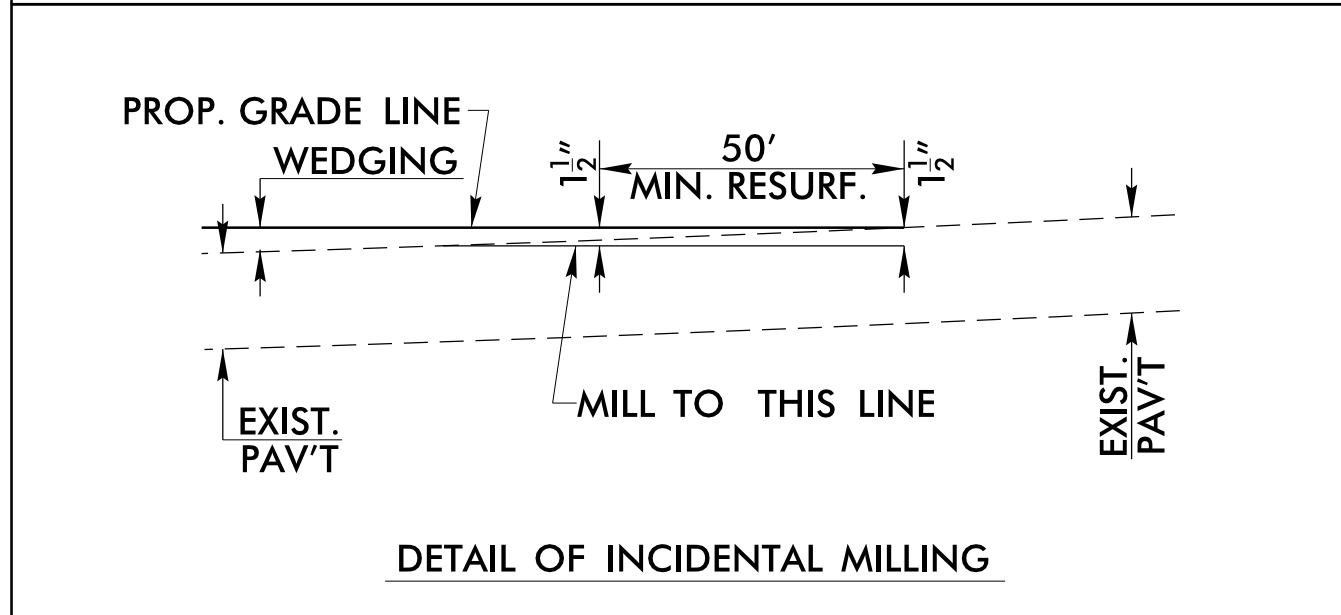
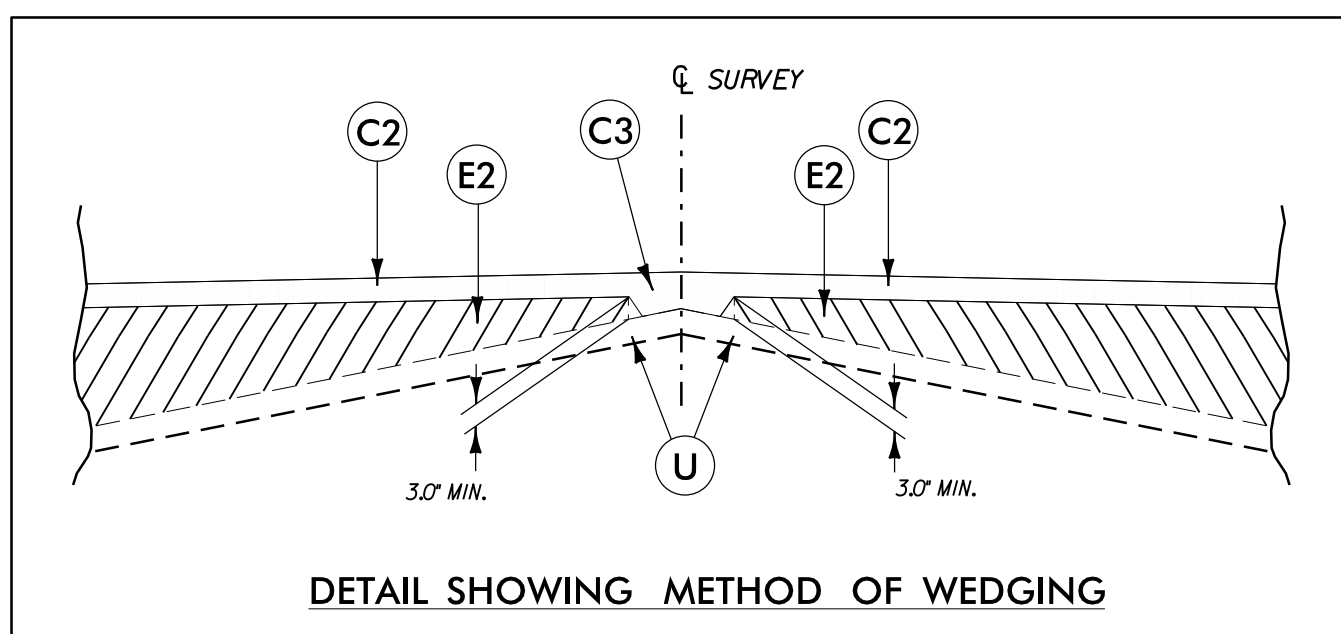

J:\Barbados Blvd - Curve\Roadway\Proj\Barbados.RDY\_TYP\_2A-1.dgn  
 16-SEP-2020 12:57  
 \$\$\$USERNAME\$\$\$

STATE OF NORTH CAROLINA  
DEPT. OF TRANSPORTATION  
DIVISION OF HIGHWAYS  
RALEIGH, N.C.

ENGLISH DETAIL DRAWING FOR  
**METHOD OF CLEARING**  
MODIFIED METHOD - III

SHEET 1 OF 1  
**200D03**

STATE OF NORTH CAROLINA  
DEPT. OF TRANSPORTATION  
DIVISION OF HIGHWAYS  
RALEIGH, N.C.

ENGLISH DETAIL DRAWING FOR  
**METHOD OF CLEARING**  
MODIFIED METHOD - III

SHEET 1 OF 1  
**200D03**

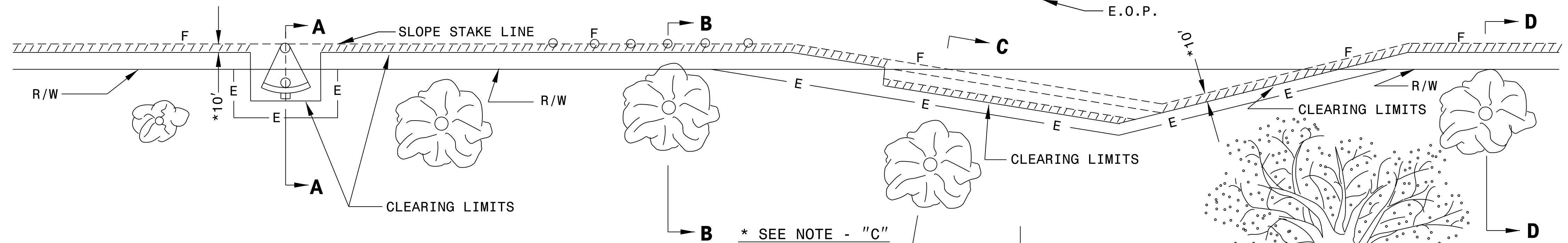
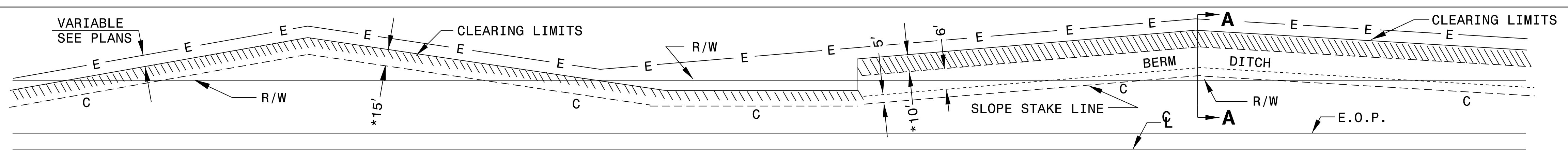

**GENERAL NOTES:**

1. REMOVE TREES OUTSIDE THE CLEARING LIMIT WHEN, IN THE OPINION OF THE ENGINEER, THE UTILITY OF A TREE WILL BE DESTROYED BY THE CONSTRUCTION OR THE CLEARING OPERATION.
2. CLEAR IN ACCORDANCE WITH THIS STANDARD EXCEPT WHERE ADDITIONAL CLEARING IS REQUIRED FOR SAFETY AS SHOWN ON THE PLANS.

**METHOD III CLEARING LIMITS**

- (A) CUTS -- CLEAR TO CONSTRUCTION LIMITS.
- (B) FILLS - CLEAR TO 5'/10' \* BEYOND CONSTRUCTION LIMITS, UNLESS SPECIFIED OTHERWISE BY WETLAND PERMIT.
- (C) CUTS AND FILLS - WHEN THE CLEARING LIMITS (A AND B) EXCEED THE PROPOSED R/W OR PROPOSED CONSTRUCTION EASEMENTS, THEN CLEAR ONLY TO THE R/W OR CONSTRUCTION EASEMENT WHICHEVER IS GREATER.

- \* FOR FILL HEIGHTS LESS THAN 10' CLEAR TO 5' BEYOND CONSTRUCTION LIMITS.
- \* FOR FILL HEIGHTS 10' OR GREATER CLEAR TO 10' BEYOND CONSTRUCTION LIMITS.
- \*\* PLACE SILT FENCE AT 5' BEYOND TOE OF SLOPE IN FILL SECTIONS WITH LESS THAN 10'. PLACE SILT FENCE AT 10' BEYOND TOE OF SLOPE IN FILL SECTIONS WITH 10' OR GREATER.

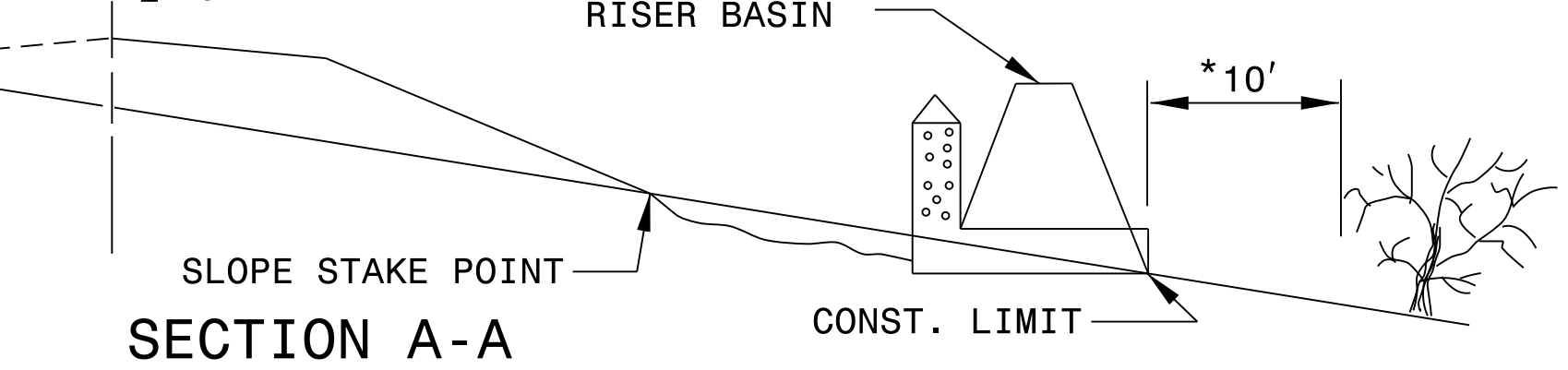
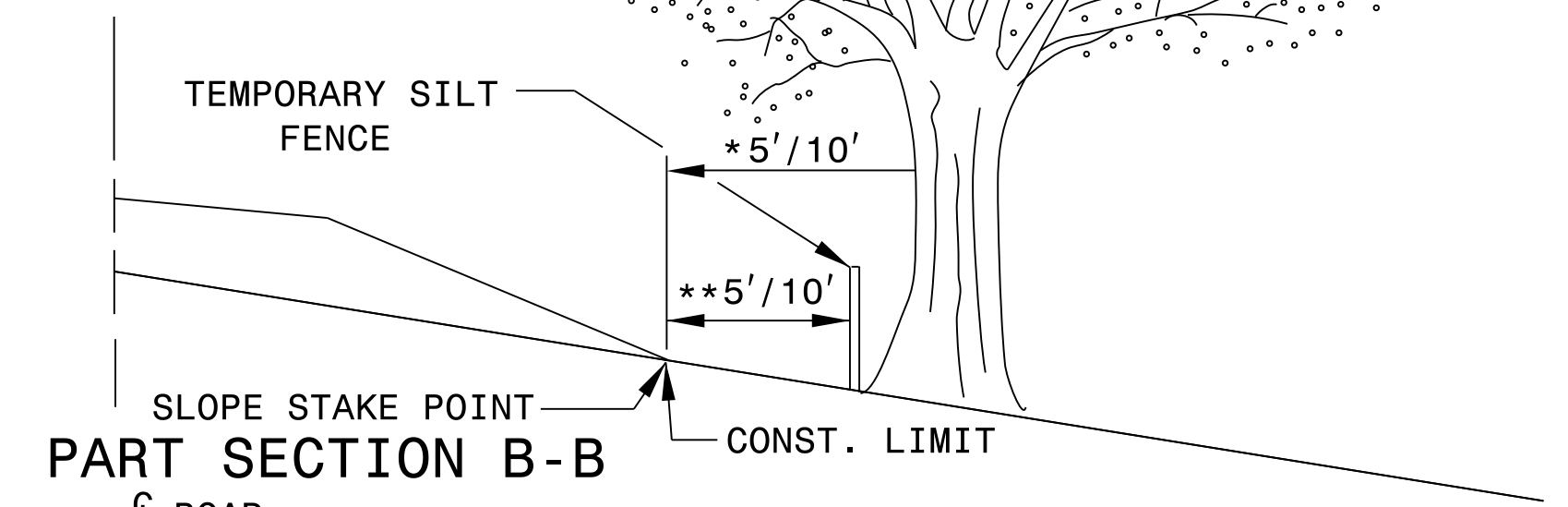
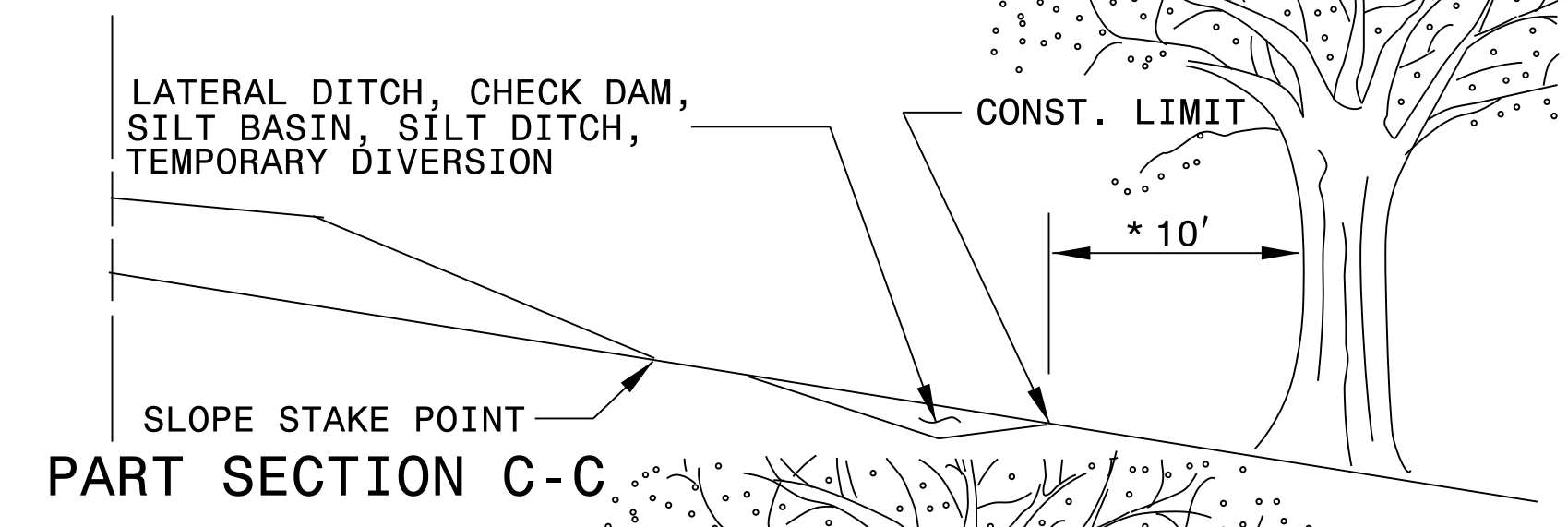
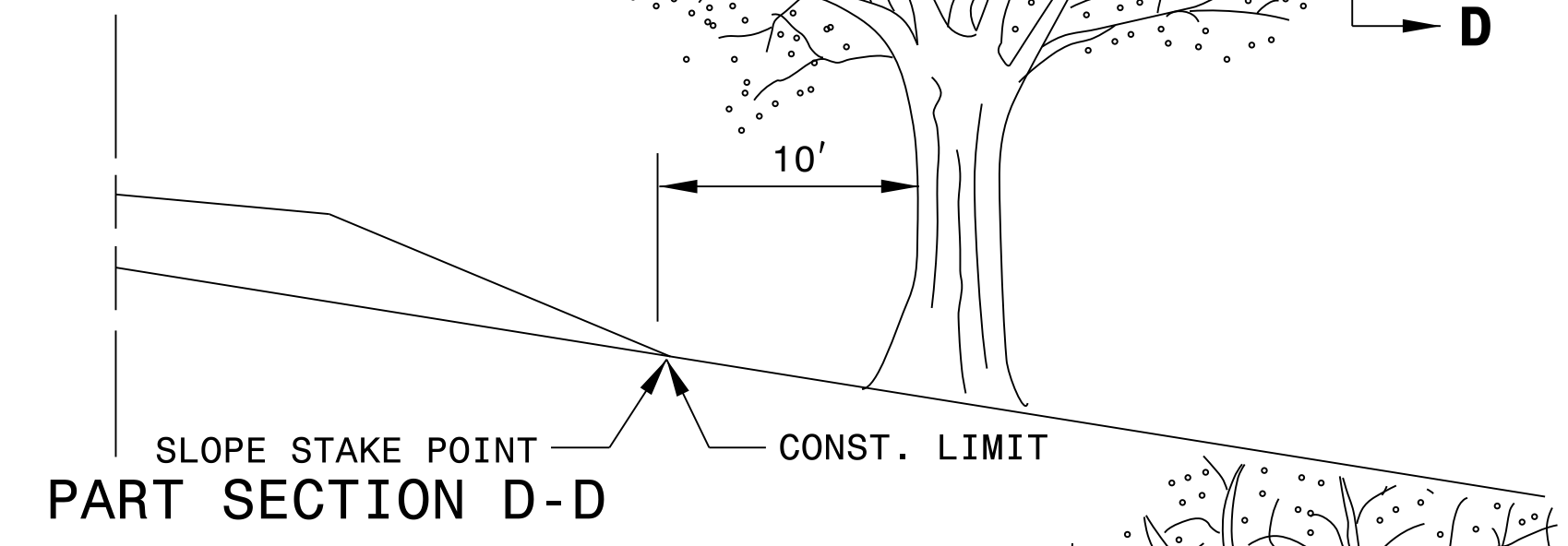
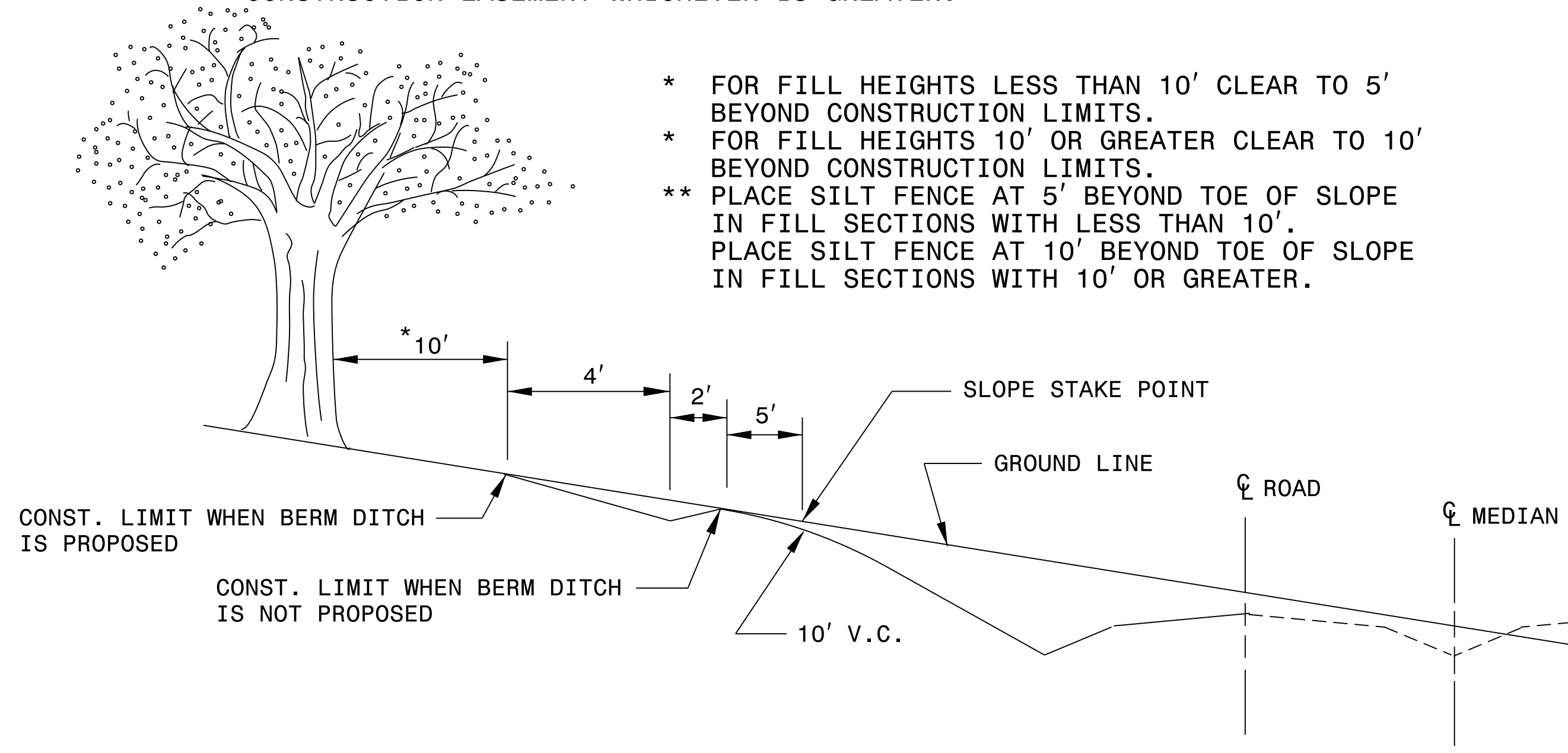

05-DEC-2017 10:43:11 S:\Contracts\Special\Details\kkempf\english\0200d301.modified.method III Cond.dgn J:\overton AT\_CSD-292595

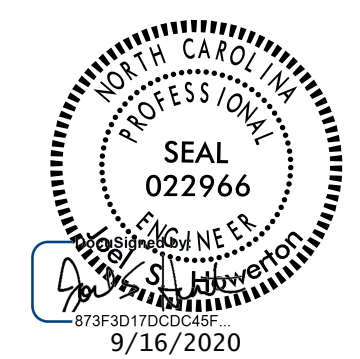

**CONTRACT STANDARDS AND DEVELOPMENT UNIT**  
Office 919-707-6950 FAX 919-250-4119

**SEE TITLE BLOCK**

ORIGINAL BY: T.S.S. DATE: FEB. 2000  
 MODIFIED BY: K.A.K. DATE: AUG. 2016  
 CHECKED BY: DATE:  
 FILE SPEC.: kkempf/english/0200d301.dgn

DOCUMENT NOT CONSIDERED FINAL UNLESS ALL SIGNATURES COMPLETED

5/28/99

COMPUTED BY: JMP DATE: 4-2019  
CHECKED BY: DLW DATE: 4-2019

STATE OF NORTH CAROLINA  
DIVISION OF HIGHWAYS

**SUMMARY OF EARTHWORK**

STATION	STATION	UNCL. EXCAV.	UNDERCUT	EMBANK.	BORROW	WASTE
-L- 11+40.00	-L- 15+40.00	21		114	93	
SUBTOTALS:		21		114	93	
PROJECT TOTALS:		21		114	93	
PROJECT TOTAL		21		114	93	
EST. 5% TO REPLACE TOP SOIL ON BORROW PIT					5	
GRAND TOTALS:		21		114	98	
SAY:		25			100	

NOTE: APPROXIMATE QUANTITIES ONLY. UNCLASSIFIED EXCAVATION, BORROW EXCAVATION, FINE GRADING, AND CLEARING AND GRUBBING WILL BE PAID FOR AT THE LUMP SUM PRICE FOR "GRADING".

I:\SEP\_2020\_12157  
11\Barbados\Roadway\Proj\Barbados.RDY\SUM\_3B-1.dgn  
\$\$\$\$\$USERNAME\$\$\$\$\$



8/17/99  
15-SEP-2020 12:57  
I:\Projects\Roadway\Proj\Barbados.RDY\_PSH\_04.dgn  
I:\Projects\Roadway\Proj\Barbados.RDY\_PSH\_04.dgn  
I:\Projects\Roadway\Proj\Barbados.RDY\_PSH\_04.dgn

PI Sta 13+50.01  
 $\Delta = 55^\circ 49' 22.6''$  (RT)  
D = 23' 52' 23.7"  
L = 233.83'  
T = 127.14'  
R = 240.00'  
R.O. = 64.00'  
SE = 0.04  
DS = 25 MPH

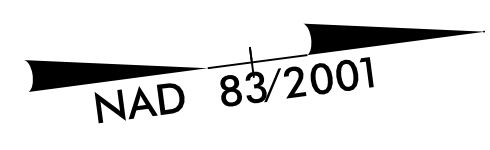

PROJECT REFERENCE NO.	SHEET NO.
2021CPT.03.03.20651	4

RW SHEET NO.

ROADWAY DESIGN ENGINEER

**DOCUMENT NOT CONSIDERED FINAL  
UNLESS ALL SIGNATURES COMPLETED**

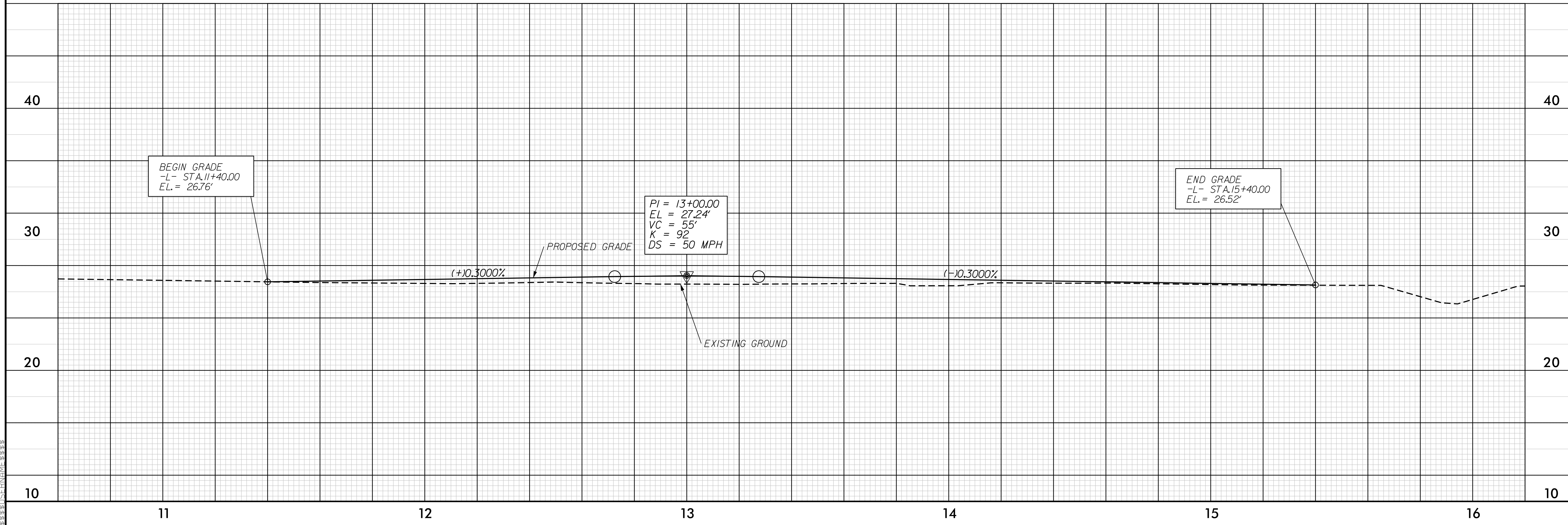
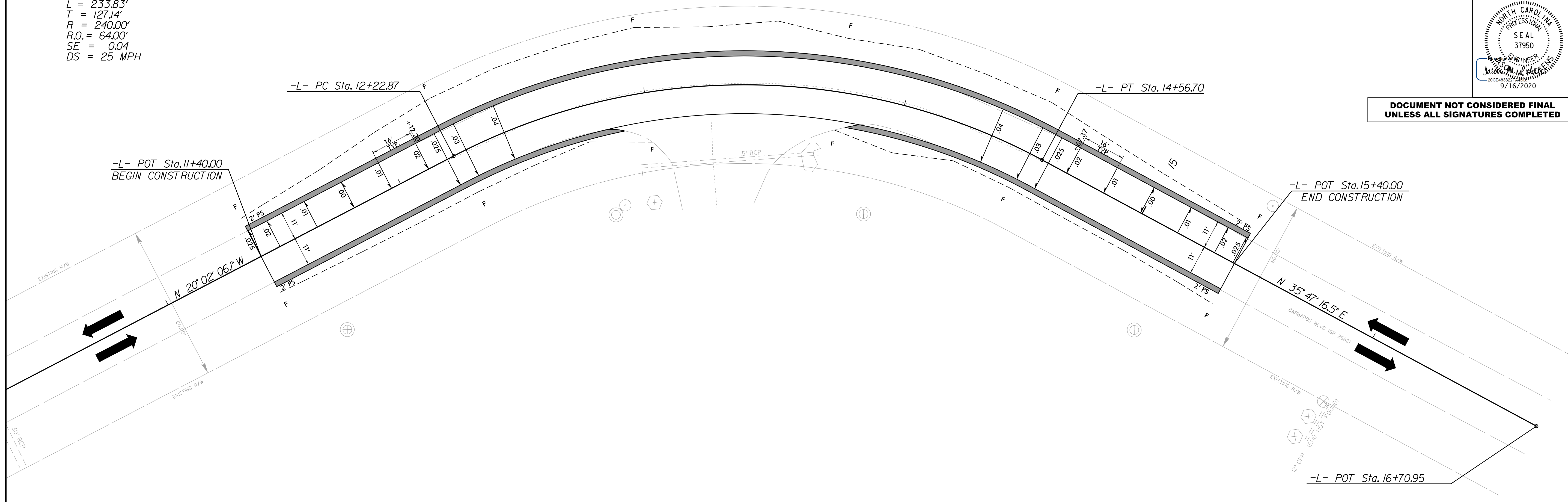

STATE OF NORTH CAROLINA  
DIVISION OF HIGHWAYS

APPROXIMATE QUANTITIES ONLY. UNCLASSIFIED EXCAVATION, BORROW EXCAVATION, FINE GRADING, AND CLEARING AND GRUBBING WILL BE PAID FOR AT THE LUMP SUM PRICE FOR "GRADING".

### CROSS-SECTION SUMMARY

Station	Uncl. Exc.	Embt	Station	Uncl. Exc.	Embt	Station	Uncl. Exc.	Embt	Station	Uncl. Exc.	Embt	Station	Uncl. Exc.	Embt	Station	Uncl. Exc.	Embt
-L-	(cu. yd.)	(cu. yd.)		(cu. yd.)	(cu. yd.)		(cu. yd.)	(cu. yd.)		(cu. yd.)	(cu. yd.)		(cu. yd.)	(cu. yd.)		(cu. yd.)	(cu. yd.)
11+40.00		0															
11+50.00		1															
11+75.00		2															
12+00.00		1			3												
12+25.00		1			6												
12+50.00		1			9												
12+75.00		1			10												
13+00.00		0			12												
13+25.00		0			11												
13+50.00		0			9												
13+75.00		0			7												
14+00.00		1			6												
14+25.00		2			6												
14+50.00		2			5												
14+75.00		2			3												
15+00.00		2			2												
15+25.00		3			1												
15+40.00		2			0												





75 70 65 60 55 50 45 40 35 30 25 20 15 10 5 0 5 10 15 20 25 30 35 40 45 50 55 60 65 70 75

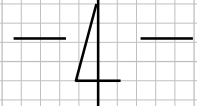
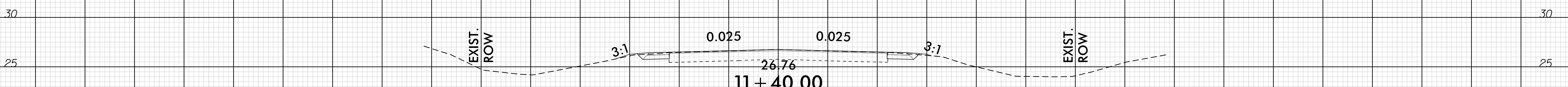
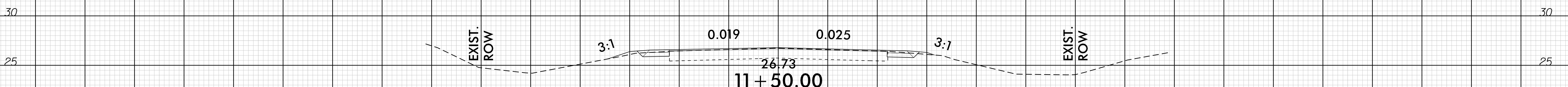
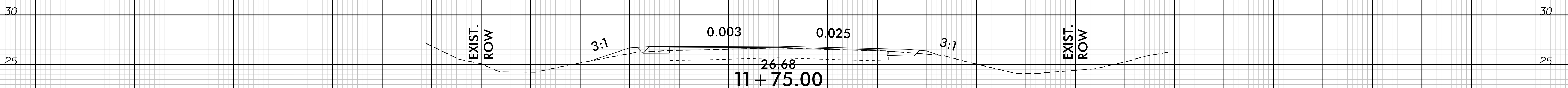
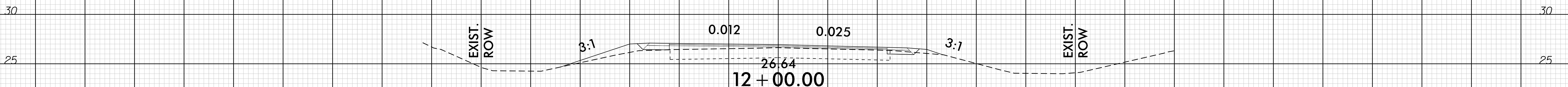
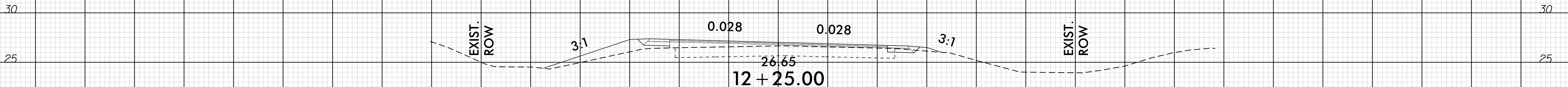
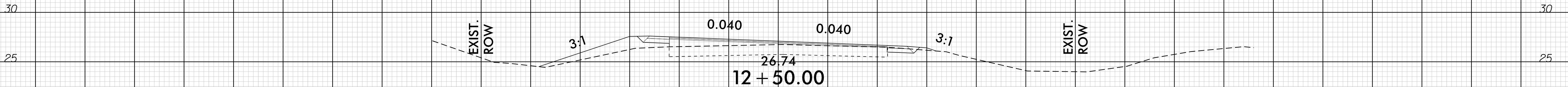

75 70 65 60 55 50 45 40 35 30 25 20 15 10 5 0 5 10 15 20 25 30 35 40 45 50 55 60 65 70 75



75 70 65 60 55 50 45 40 35 30 25 20 15 10 5 0 5 10 15 20 25 30 35 40 45 50 55 60 65 70 75

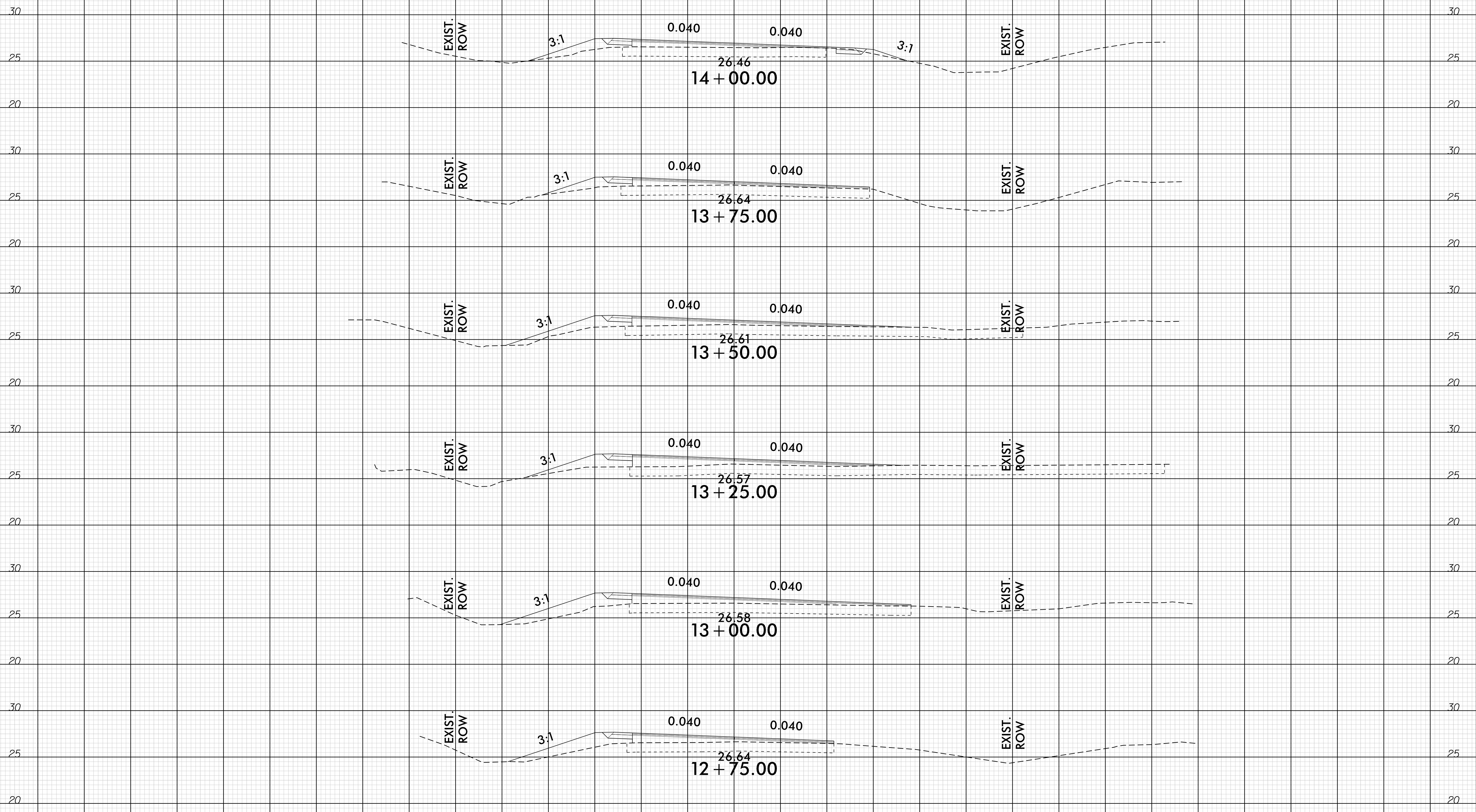

75 70 65 60 55 50 45 40 35 30 25 20 15 10 5 0 5 10 15 20 25 30 35 40 45 50 55 60 65 70 75

